

STEEL, STAINLESS STEEL, ALUMINUM, CUSTOM DRY SUMP PANS



9131

Aluminum Dry Sump (SBC or Rocket)



9170

Ford Aluminum Dry Sump



9134

Vortex Dry Sump
in 4" or 5" depth



9290

Stainless Big Block Marine



9132

Economy Dry Sump

DRY SUMP SYSTEM SCHEMATIC

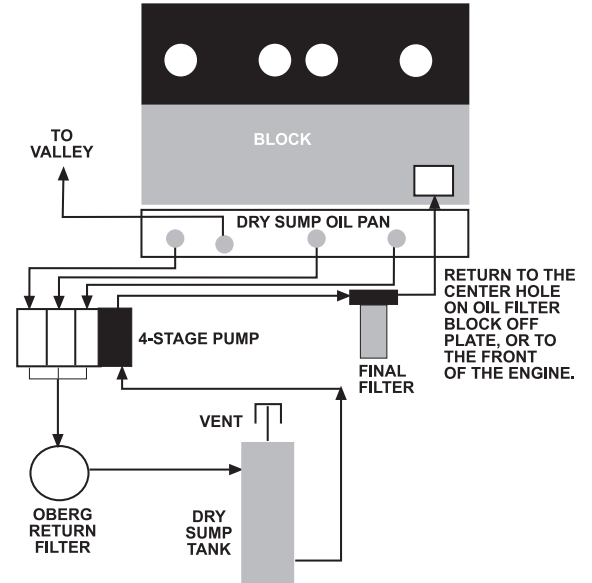

DRY SUMP FEATURES

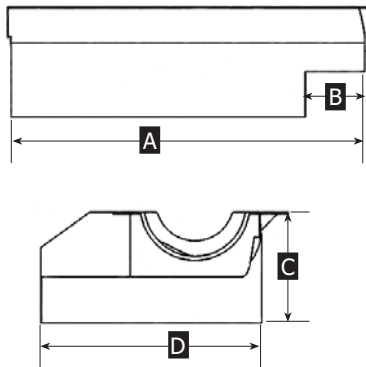

- ♦ Better design means **more efficient oil management** through
 - 3-stage adjustable scraper systems that quickly and efficiently removes oil from the crank
 - unidirectional screen and oil dams to control oil flow
- ♦ Top **quality construction**, featuring Tig welding on laser cut steel components. All are 100% made in USA. Steel oil pans are given an e-coat finish, the automotive OEM standard for protective durability (except stainless steel).
- ♦ **Billet rails and ends** are used on all aluminum oil pans for added strength and durability.
- ♦ **Custom oil pans** also available made from steel, aluminum or stainless steel. Call for details.

DRY SUMP OIL PANS

PART #	BLOCK	A	B	C	D	DETAILS
9131	SBC	20"	n/a	4.25"	11"	Aluminum dry sump oil pan with billet ends and rail
9131-R	Rocket	20"	n/a	4.25"	11"	Aluminum dry sump oil pan with billet ends and rail
9132	SBC	21"	n/a	5.5"	7.5"	Economy dry sump; single scraper, no kickout
9134-4	SBC	20"	4.25"	4"	8.75"	3-stage scraper, 3 #12 AN
9134-5	SBC	20"	4.25"	5"	8.75"	Best for bigger cubic inch engines, 3 #12 AN
9170	Ford	20"	n/a	5"	16"	Aluminum dry sump for Ford Windsor SVO block.

MARINE

9290	BBC	22.5"	n/a	7.25"	10.75"	Strong 304 stainless, corrosion resistant
------	-----	-------	-----	-------	--------	---